



**2020 European Rowing Indoor
Championships /
2020 Czech Rowing Indoor National
Championships**

Královka Hall

Nad Královskou oborou 1080/51

170 00 Praha 7

Prague, Czech Republic

Saturday, January 11, 2020

The **European Rowing Confederation (ERC)**, in partnership with the **Czech Rowing Association** and **Concept2**, are proud to host the **2020 European Rowing Indoor Championships** and the **2020 Czech Rowing Indoor National Championships** on Saturday, January 11, 2020, at the **Královka Hall** in Prague.

Please read this bulletin in its entirety, as it contains important information about this year's event.



Table of Contents

Important Dates	4
Organising Committee	4
Event List:.....	5
Entry Information:	7
Entry Fees:.....	8
Withdrawals:.....	8
Competition Information	8
Event Age Classifications:	8
Para Rowing Events.....	10
Affiliation:	11
Mixed Events:.....	11
Rules:	11
Weigh-Ins / Lightweight	12
Anti-Doping:.....	12
Equipment:	13
Outside Assistance:	13
Practice Information:	13
Medals and Awards:.....	13
Venue Information	14
Hotel Information.....	15
About Prague.....	17
Getting Around	19
Contact Information:	19

Important Dates

- October 1, 2019 -- Online registration opens on [RegattaCentral](#)
- December 15, 2019 at 23:59 (CET) -- Initial online registration deadline. All entry fees become non-refundable after this deadline.
- December 16, 2019 -- Online late entry registration opens.
- December 31, 2019 at 23:59 (CET)-- Online late entry deadline.
- January 3, 2020-- Initial race schedule posted.
- January 10, 2020 from 18:00 to 20:00 hrs and January 11, 2020 from 7:00 hrs onwards -- On-site race card pick-up is available.

Racing will take place **all day on Saturday, January 11, 2020**. A complete racing schedule will be available following the close of entries. Under no circumstances will races be run after January 11, 2020.

All racing is a finals-only format, regardless of the number of entries in each event. If there is more than one heat for a particular event, the fastest time overall will determine the winner. Races will be seeded by time within an event. Award ceremonies will be held as described in the Medals section of this bulletin.

Organising Committee

President of the OC:	Dušan MACHÁČEK
Executive director:	Lucie MAKOVIČKOVÁ
Technical director:	Petr ŠVEŇHA
Visa services:	Josef JOHÁNEK
Chair of the Jury:	Marek LORENC
Media:	Vítězslav HUJA
Ceremonies:	Jana HELLEROVÁ
Para-rowing:	Petr JANÁK
Volunteers:	Monika PERGLEROVÁ
Regatta doctor:	Veronika ŠKVOROVÁ, MD
Videostream:	Art Media
Entry system:	RegattaCentral, Sportis (for Czech Rowing Association entries)
Time keeping, results:	Time-Team
Merchandising:	New Wave

Event List

A - 2000m EVENTS

EUROPEAN OPEN / CZECH ROWING INDOOR NATIONAL CHAMPIONSHIPS

2.000m MASTERS EVENTS

1. Master 30-39 Men
2. Master 30-39 Women
3. Master 30-39 Lightweight Men
4. Master 30-39 Lightweight Women
5. Master 40-49 Men
6. Master 40-49 Women
7. Master 40-49 Lightweight Men
8. Master 40-49 Lightweight Women
9. Master 50-54 Men
10. Master 50-54 Women
11. Master 50-54 Lightweight Men
12. Master 50-54 Lightweight Women
13. Master 55-59 Men
14. Master 55-59 Women
15. Master 55-59 Lightweight Men
16. Master 55-59 Lightweight Women
17. Master 60-64 Men
18. Master 60-64 Women
19. Master 60-64 Lightweight Men
20. Master 60-64 Lightweight Women
21. Master 65-69 Men
22. Master 65-69 Women
23. Master 65-69 Lightweight Men
24. Master 65-69 Lightweight Women
25. Master 70-74 Men
26. Master 70-74 Women
27. Master 70-74 Lightweight Men
28. Master 70-74 Lightweight Women
29. Master 75-79 Men
30. Master 75-79 Women
31. Master 75-79 Lightweight Men
32. Master 75-79 Lightweight Women
33. Master 80-84 Men
34. Master 80-84 Women
35. Master 85-89 Men
36. Master 85-89 Women
37. Master 90-94 Men
38. Master 90-94 Women
39. Master 95-99 Men
40. Master 95-99 Women
41. Master 100 and over Men
42. Master 100 and over Women

EUROPEAN OPEN / CZECH ROWING INDOOR NATIONAL CHAMPIONSHIPS

2000m EVENTS U17, U19, U23

43. Under 17 (Junior B) Men
44. Under 17 (Junior B) Women
45. Under 19 (Junior) Men
46. Under 19 (Junior) Women

CZECH ROWING INDOOR NATIONAL CHAMPIONSHIPS

2000m PARA-ROWING EVENTS (Without FISA Classification)

47. Men PR1
48. Women PR1
49. Men PR2
50. Women PR2
51. Men PR3
52. Women PR3

EUROPEAN ROWING INDOOR CHAMPIONSHIPS

2000m PARA-ROWING EVENTS (Require FISA Classification)

53. Men PR1
54. Women PR1
55. Men PR2
56. Women PR2
57. Men PR3
58. Women PR3

EUROPEAN OPEN / CZECH ROWING INDOOR NATIONAL CHAMPIONSHIPS

59. Under 23 Lightweight Men
60. Under 23 Lightweight Women
61. Under 23 Men
62. Under 23 Women

EUROPEAN ROWING INDOOR CHAMPIONSHIPS / CZECH ROWING INDOOR NATIONAL CHAMPIONSHIPS

2000m OPEN EVENTS

63. Senior Lightweight Men
64. Senior Lightweight Women
65. Senior (Open) Men
66. Senior (Open) Women

B - 1000m

EUROPEAN OPEN

1000m EVENTS OPEN, MASTERS

67. Master 30-39 Men
68. Master 30-39 Women
69. Master 40-49 Men
70. Master 40-49 Women
71. Master 50-54 Men
72. Master 50-54 Women
73. Master 55-59 Men
74. Master 55-59 Women
75. Master 60 and over Men
76. Master 60 and over Women
77. Senior (Open) Women
78. Senior (Open) Men

C - 500m SPRINTS

EUROPEAN OPEN

500m EVENTS U17, U19, U23, OPEN, MASTERS

79. Master 30-39 Men
80. Master 30-39 Women
81. Master 40-49 Men
82. Master 40-49 Women
83. Master 50-54 Men
84. Master 50-54 Women
85. Master 55-59 Men
86. Master 55-59 Women
87. Master 60 and over Men
88. Master 60 and over Women
89. Under 17 (Junior B) Men
90. Under 17 (Junior B) Women
91. Under 19 (Junior) Men
92. Under 19 (Junior) Women
93. Under 23 Men
94. Under 23 Women
95. Senior (Open) Lightweight Men
96. Senior (Open) Lightweight Women
97. Senior (Open) Women
98. Senior (Open) Men

C - TEAM EVENTS

EUROPEAN OPEN

EVENTS 4x500m Team Relays

99. 4x500m U17 Mix (2M+2W)
100. 4x500m U19 Mix (2M+2W)
101. 4x500m OPEN Mix (2M+2W)
102. 4x500m MASTERS 40 and over Mix (2M+2W)

EVENTS 4 minutes Team

103. Four (slides) OPEN Men
104. Four (slides) OPEN Women
105. Four (slides) OPEN Mix

Lightweights (Rule 31)

For an international indoor rowing event, no individual lightweight male rower may weigh more than 75 kgs and no individual female rower may weigh more than 61.5 kgs. Lightweight rowers shall be weighed wearing only their racing uniform on tested scales not less than one hour and not more than two hours before their first race of each lightweight event in which they are competing, each day of the competition.

For the avoidance of doubt there shall be no lightweight categories for juniors.

International Competitors

International competitors, regardless of whether they are members of a club or association affiliated with a national rowing federation that is a member federation of ERC, shall be responsible for their own adequate medical and accident insurance, as well as insurance covering liability, property and equipment.

Race Cards will be issued to competitors on Friday, January 10 from 18:00 to 20:00 hrs and on Saturday, January 11 from 7:00 hrs at Athlete Check-in at the race venue (Královka Hall, Prague). Race Cards will be available for pick up by Club Affiliation.

Unaffiliated rowers will pick up Race Cards under the listing “Unaffiliated” and then by name. Race cards must be picked up no later than one hour prior to race time.

Competitors will be required to show their Race Card in order to weigh-in and to enter the Competition Floor.

Lightweight competitors must pick up their Race Cards before weighing in.

Entry Information

No paper entries will be accepted for this event. All entries must be made online at [RegattaCentral](#). Entry system opens on October 1, 2019 with an initial registration deadline on December 15, 2019. No refunds will be given once the initial registration period has ended. The final registration deadline is December 31, 2019. All entry fees must be paid in full by December 31, 2019. After this date, unpaid entries will be considered late entries and subject to the additional fees associated with such designation.

Entry Fees

Entry fee is EUR 25.00 for all individual events. For the team relays and Slides (Four), the team entry fee is total EUR 35.00. A late fee of EUR 10.00 will be charged for any entries accepted during the Late Entry period (after December 16).

Entry fees become non-refundable on December 15, 2019.

A limited number of late entries might be accepted (depending on availability) at the Registration desk at the Competition Venue on January 10, 2020. This on-site registration will be available on a first-come, first-serve basis from 18:00 – 20:00 hrs and up to 3 hours before the race time. The on-site entry fee is EUR 40.00 for single entries, EUR 60.00 total for the team relay and slides (Four).

All late entries must be submitted with complete information including name of competitor and date of birth. Relay entries must provide complete information for each member of the relay.

Withdrawals

Entries may be withdrawn without penalty until the end of the initial registration period on December 15, 2019.

Beginning December 16, 2019, no refunds will be given for withdrawals.

Competition Information

Event Age Classifications

The age determination of the competitor for this competition would be their age on 31st December 2020.

Under 17: Under 17 rower shall not have attained the age of 17 by 31 December 2020

Under 19: Under 19 rower shall not have attained the age of 19 by 31 December 2020

Under 23: Under 23 rower shall not have attained the age of 23 by 31 December 2020

Senior (Open): Senior (Open) events are open to competitors of any age.

Masters: Masters competitors are required to race within the event designated for their age category. Competitors are not eligible to race in events designated for older or younger categories.

Masters Age Categories

Category - Ages
30-39
40-49
50-54
55-59
60-64
65-69
70-74
75-79
80-84
85-89
90-94
95-99
100 and over

Para Rowing Events

EUROPEAN ROWING INDOOR CHAMPIONSHIPS PARA EVENTS – FISA CLASSIFICATION IS MANDATORY

FISA Classification is required for the European Rowing Indoor Championships PR1, PR2, and PR3 events. To view the list of athletes who have been internationally classified, please view the Master Athlete Classification List on the [Para Rowing Information page](#) of the FISA Website.

Athletes taking part in these events who have not yet been internationally classified may request to be classified the day prior to competition (10 January 2020). In order to do so, athletes must submit medical documentation to FISA (links below). These documents must be submitted via the athlete's National Federations using the FISA Classification portal 45 days prior to classification, i.e. no later than **26 November 2019**. Athletes and their National Federations that submit documentation after this deadline will not be guaranteed a classification opportunity. If a Czech para athlete is not able to be classified, they will be able to enter the Czech Rowing Indoor National Championship events, which do not require FISA classification. Non-Czech European Athletes who are not able to be classified would not be able to enter the para rowing events at the 2019 European Rowing Indoor Championships

Please note that only physical impairment classification will be available at this event. Visually impaired athletes requiring a classification will need to follow the above process with regards to documentation, and will be issued a temporary classification for this event if they are found to be eligible based on their documentation.

For questions about international classification, please email classification@fisa.org

Please see below links to the FISA Para Rowing Classification regulations and the Medical Diagnostics forms for Physical Impairment and Visual Impairment

Appendix 19

[FISA Para Rowing Classification Regulations](#)

[FISA Medical Diagnostics Form for PHYSICAL IMPAIRMENT](#)

[FISA Medical Diagnostics Form for VISUAL IMPAIRMENT](#)

FISA has created an online tool to help potential para athletes determine their eligibility for para rowing and to give an indication of what sport class they may be eligible for. The online tool is

available [HERE](#).

CZECH ROWING INDOOR NATIONAL CHAMPIONSHIPS PARA EVENTS – FISA CLASSIFICATION IS NOT MANDATORY

Affiliation

A competitor shall represent only one organization at the competition.

Composite Entries (Team Events):

Composite entries are allowed to compete in the Relays and Four (slides) events. Composite entries must include the affiliation of each member of the relay team.

Mixed Events

A crew competing in a mixed event must be 50% male and 50% female.

Rules

FISA RULES OF RACING FOR INDOOR ROWING will be used to govern this event. The Regulations shall apply to all events except as shown below, where the European Rowing Board has exercised its authority to allow exceptions to the Regulations.

The exceptions are:

- Any member of the medical staff has the authority to pull an athlete for medical reasons at any time.
- Age eligibility for all age category events shall be determined by the rower's age on December 31, 2020.
- Athletes who registered as a lightweight and fail to weigh in for any reason may row at their originally assigned time and erg. Results will be recorded in the corresponding open weight event.
- Rowers who make more than one false start in a single event may be disqualified at the discretion of competition officials.
- If the rower's erg becomes disconnected from the Concept2 Venue Racing System, the rower must not stop rowing. All data is retained on the PM5. If any other mechanical problem develops early during an event, a regatta official should be alerted immediately.

The rower may be moved to an unoccupied erg or their race rescheduled following an appropriate rest period.

- Special Note: Objections, Protests, Appeals shall be subject to the Regulations (pages 406 – 408, FISA Rules of Racing - Appendix 24, Indoor Rowing Competition Regulations - http://www.worldrowing.com/mm//Document/General/General/12/68/94/FISArulebookEN2017finalweb4_Neutral.pdf

Each participant taking part in the 2020 European Rowing Indoor Championships is responsible to ensure that they have adequate medical and accident insurance as well as insurance covering liability, property and equipment.

Weigh-Ins / Lightweights

FISA's Rules of Racing - Indoor Rowing Competition Regulations will be used to govern this event.

For an indoor rowing event, no individual lightweight **male rower** may weigh more than **75 kg** and no individual **female rower** may weigh more than **61.5 kg**.

Lightweight rowers shall be weighed wearing only their racing uniform on tested scales not less than one(1) hour and not more than two (2) hours before their first race of each lightweight event in which they are competing, each day of the competition. Lightweight competitors must pick up their Race Cards before weighing in.

Anti-Doping

The authority of ERC regarding anti-doping is set out in ERC's (FISA's) Statutes, Rules and Bye-Laws and the World Anti-Doping Code and Regulations and includes the ability to implement in- and

out-of-competition drug testing and the biological passport. All participants must sign the ERC (FISA) Rower's Commitment Form/Event Release of Liability during online registration, which includes a clause on Anti-Doping, and may be subject to anti-doping testing at this year's event.

More information can be found at the following links:

FISA's Anti-Doping Regulations:

http://www.worldrowing.com/mm//Document/General/General/13/13/18/Appendix14-Antidoping2018update_Neutral.pdf

World Anti-Doping Agency (WADA) Code: <https://www.wada-ama.org/en/what-we-do>

Equipment

All equipment used in competition will be provided by the organisers. Modifications will not be allowed by competitors except as approved by the Para Committee for the PR1, PR2, and PR3 events. No external software will be permitted.

Outside Assistance

Crews are reminded that they are not to receive outside assistance during a race except from the unaided voice. Para visually impaired rowers may receive verbal status only from a coach or coxswain.

Practice Information

Warm-up ergometers will be available just off the competition floor with absolute priority given to competitors for the next race taking place on the race floor.

Medals and Awards

ERC will present European championship medals (gold, silver and bronze) to the top three finishers in all events designated as European Rowing Indoor Championships events (Events 53 - 58, 63 - 66).

Czech Rowing Association will present national championship medals (gold, silver, and bronze) to the top three Czech finishers in all events designated as Czech Rowing Indoor National Championship events (Events 1 - 52, 59 - 66).

The Organising Committee will present Euro open medals (gold, silver and bronze) to the top three finishers in all Euro open categories (Events 1 - 52, 59 - 62, 67 - 105).

Venue Information

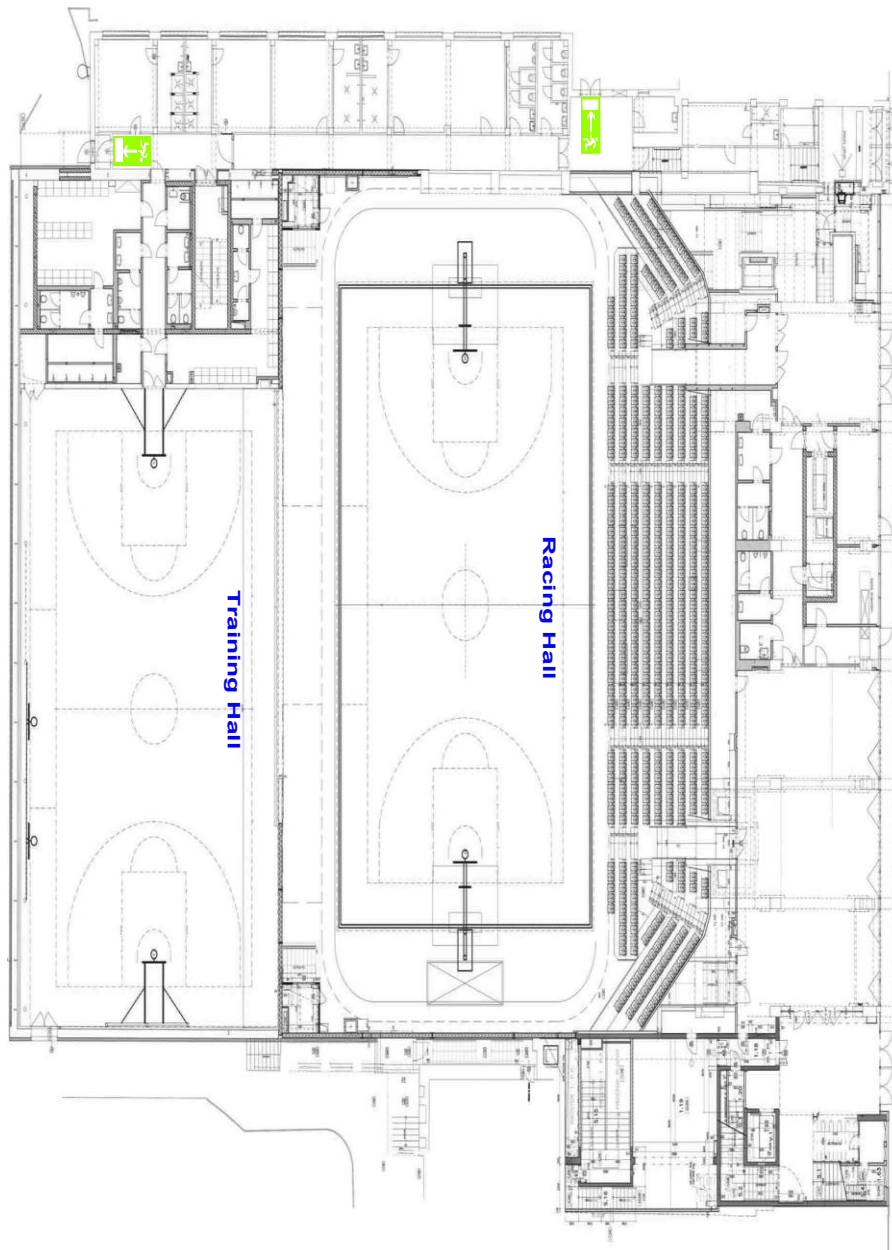

The competition will be held at the **Královka hall**, a World-class basketball facility used mainly of top European basketball team USK Praha. This venue is regularly used for collegiate basketball, volleyball, and similar events. More info on www.sapraha.cz .

The Královka hall location is in the neighborhood of AC Sparta Praha football stadium and minutes away from the Prague's Castle.

For purposes of driving directions, the address of the Královka hall is **Sportovní hala Královka, Nad Královskou oborou 1080/51, 170 00 Praha 7-Bubeneč**. Inquiries should NOT be sent to that address.

The **Královka hall** is best reached by car or by TRAM No. 1, 8, 12, 25 and 26 which is 250 m walk from the **Sparta** tram station. Please refer to the <http://spojeni.dpp.cz/ZirForm.aspx?cl=E5> for English version of tram schedule. More useful information regarding traveling in Prague (public transport fares included) can be found at www.prague.en.

Limited pay parking places are around the Královka hall in "violet" Zones. The Organising Committee recommends to let the cars in non-stop underground parking Garage Letna www.garazeletna.cz, which is placed 300 m from the venue.

Hotel Information

The official hotel for the ERIC 2020 is the **Orea Hotel Pyramida **** Prague**, which is located at the quiet location near the Prague Castle, just 15 minutes drive from the Václav Havel Airport, Prague. The hotel is easily accesible by public transportation (the **Malovanka** tram stop) and by car which can be parked in the hotel's parking lot.

All guests of the Orea Hotel Pyramida have an access to the Nebula Restaurant where the breakfast is served, Franz Kafka Lobby bar that serves the aromatic cofee with home-made cakes, and Relaxation centre with swimming pool and sauna.

The Královka Hall venue is just 15 minutes away by public transport – tram No. **25**. The **Malovanka** tram stop is located in front of the hotel, tram runs every 15 minutes to the **Sparta** tram stop, the Královka Hall venue. Please refer to the <http://spojeni.dpp.cz/ZirForm.aspx?cl=E5> for English version of tram No. 25 schedule.

The Orea Hotel Pyramida is wheelchair accessible, there are also 4 rooms for disable guests available at this hotel.

Orea Pyramida Hotel **** Prague



Bělohorská 24
169 00 Prague 6, Czech Republic
Phone: +420 233 102 111
www.hotelpyramida.cz

Special room pricing has been arranged at the promotional rate of:

- **EUR 60** per person/night in **Classic room**, single use
- **EUR 35** per person/night in **Classic room**, double use
- **EUR 70** per person/night in **Deluxe room**, single use
- **EUR 40** per person/night in **Deluxe room**, double use

Price includes:

- Accommodation
- Breakfast
- Access to the Relaxation centre with swimming pool and sauna

Room amenities:

- Satellite TV, air conditioning
- Telephone, complimentary Wi-Fi
- Safe, tea & coffee set maker
- Bathroom: shower or bath, toilet, hair dryer -
- Small refrigerator

For the accommodation online booking please contact directly the Orea Pyramida Hotel** Prague using the special link, that will be announced on the event website www.indoor-rowing.cz during September, 2019.**

In case of any questions or problems do not hesitate to contact Mrs. Lucie Makovickova at makovickova@rowingracice.com.

About Prague

Prague – Capital City of Czech Republic

The capital of the Czech Republic is the most valuable urban conservation area in Europe. In 1992 the historical core of the city covering 866 hectares was listed in the UNESCO World Cultural and Natural Heritage Register.

Prague represents a unique collection of historical monuments dominated by Prague Castle which towers high above the city. It merges all artistic and architectonic styles and movements. The historical core of the city is situated on both banks of the Vltava river and consists of six parts - formerly independent urban units unified in the 18th century. They are as follows: Stare Mesto (Old Town), Josefov (the preserved part of the former Jewish Town - today part of the Old Town), Nove Mesto (New Town), Mala Strana (Lesser Town), Hradcany and Vysehrad. Naturally, most of the historical monuments, museums and galleries are concentrated there.

Here is the list of most attractive monuments of Prague:

Prague Castle

A castle was built on this site in the 9th century, and a Romanesque palace was erected there in the 12th century. In the 14th century, during the rule of Charles IV, it was rebuilt in the Gothic style. The Royal palace was re-built to the current shape under the Jagellos at the end of the 15th century, and at that time, the builder Benedikt Rejt added the now-famous Vladislav Hall, also in the Gothic style.

The castle was enlarged in the 16th century, especially after a big fire in 1541. The Spanish Hall, in a new part of the castle, was added during the reign of Rudolf II, and it took its final form during the reign of Empress Maria Theresa, under the direction of the architect M. Pacassi. After World War I, the interior and gardens of the castle were renovated by architect J. Plecnik. Today, the Castle is the seat of the President of the Czech Republic, and it serves as the historical and political centre of both the city and state.

St. Vitus, St. Wenceslas and St. Adalbert Cathedrals

The Gothic St. Vitus cathedral is the spiritual symbol of the Czech state. It was founded in the late 9th century by John of Luxembourg and his sons Charles and John Henry. It took nearly six centuries to build. The current cathedral is situated on the site of a 10th-century rotunda. Designed by architects Mathias Arras and Petr Parler, its construction started in 1344. The final stage of construction was completed only in the period between 1873 and 1929. There are underground tombs in the cathedral of Czech kings. Parler also built the St. Wenceslas Chapel which is decorated with frescoes and semi-precious stones. The Czech crown jewels are deposited there, too.

Old Royal Palace

The Old Royal Palace served as the residence of Bohemian princes and kings until the 16th century. It was built upon the relics of a Romanesque palace of Prince Sobeslav. Additional reconstructions in the Gothic and Renaissance styles were initiated by famous Czech kings Premysl Otakar II, Charles IV, Wenceslas IV and Vladislav Jagello. Its most noteworthy part is the Gothic Vladislav Hall - the largest profane hall of medieval Prague (1487 - 1500, Benedikt Rejt) with a remarkable rounded rib vault, today the venue of presidential elections and ceremonial events.

Golden Lane

Small houses built in the gothic fortification, the homes of 16th century castle riflemen and craftsmen. Between 1916 - 1917, Franz Kafka lived in No. 22.

Petrin Lookout Tower and Labyrinth

A reduced copy of the Eiffel Tower (60 m high) built in 1891 on the occasion of the 1891 Jubilee Exhibition. 299 steps lead up to the top platform. A maze of mirrors set up originally for the Jubilee Exhibition (1891) and featuring a diorama of "Battle of the Praguers with the Swedes in 1648 at the Charles Bridge".

Charles Bridge

Started in 1357 by Master Otto and completed by Petr Parler, this is the oldest bridge in Prague. Its statues and sculptural groups date mostly from the 18th century. The most well-known are the works of Matthias Braun and Ferdinand Maxmilian Brokoff. The bridge is 515 metres long and 10 metres wide.

Old Town Square

Dating from the 12th century, the square has witnessed many a significant event. Beside the Old Town Hall and the Church of Our Lady before Týn, the square has several other dominants - the baroque St. Nicholas church, the rococo Kinsky palace housing the National Gallery graphic collection, the Stone Bell house - a gothic palace from the 14th century, now the Municipal Gallery concert and exhibition rooms, as well as the Master Jan Hus Memorial sculptured by Ladislav Saloun. The square witnessed the execution of 27 Czech noblemen on 21 June, 1621 - in memory of that event, 27 crosses are marked in the pavement. The Prague meridian can be seen not far from there.

Wenceslas Square

Prague's centre of commerce. The upper part of the square is dominated by a statue of the main patron saint of the Czech lands, St. Wenceslas and four other Czech patron saints (St. Prokop, St. Adalbert, St. Ludmila and St. Agnes) by Josef Vaclav Myslbek. Erected in 1912.

National Theatre

A neo-Renaissance building of 1868-81, built to plans of J. Zitek. A fire destroyed much of the building in its first year of existence. It was rebuilt by architect Josef Schulz in 1883 and underwent a thorough renovation a hundred years later. The authors of both exterior and interior decorations are artists of the so-called National Theatre generation: M. Ales, F. Zenisek, V. Hynais, J. V. Myslbek, and others. The National Theatre is a major Czech stage and its repertoire includes drama, opera and ballet.

Vysehrad

The ancient seat of the Premyslide princes built on a rock over the river Vltava. The oldest building there is the rotunda of St. Martin. The main landmark of Vysehrad is the St. Peter and Paul cathedral. In its vicinity, there is a residence for canons, casemates, a park, and a cemetery called Slavín with tombs of famous personalities of Czech culture. The Southern part of the fortifications offers a beautiful view of Prague. Vysehrad is open to public round the clock.

Getting Around

All important information about Prague such as food&drink, places, events, etc. can be found at www.prague.en.

Contact Information

2020 European Rowing Indoor Championships Organising Committee

www.indoor-rowing.cz

info@indoor-rowing.cz